

Rifacimento

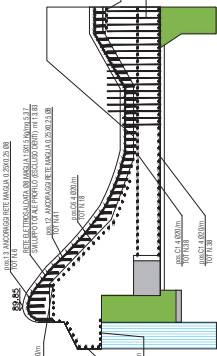

Armature di ripartizione

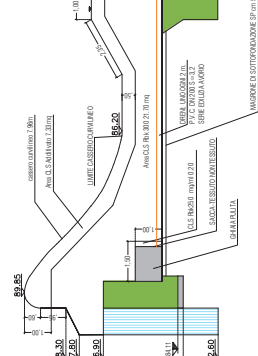

Carpenteria

Carpenteria

Rifacimento

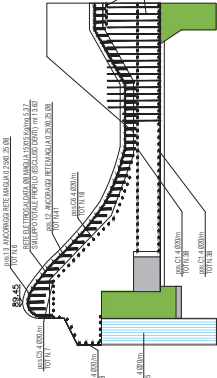

Armature di ripartizione

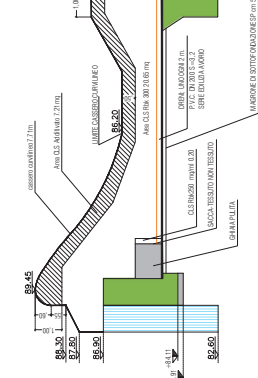

Carpenteria

Carpenteria

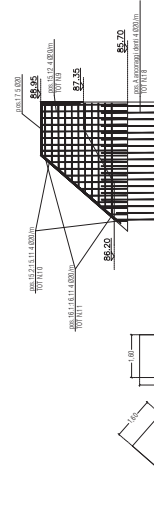

Superficie rete elettrosaldata

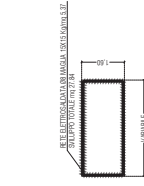

Armature

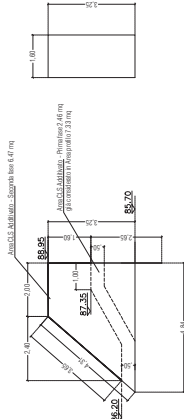

Carpenteria

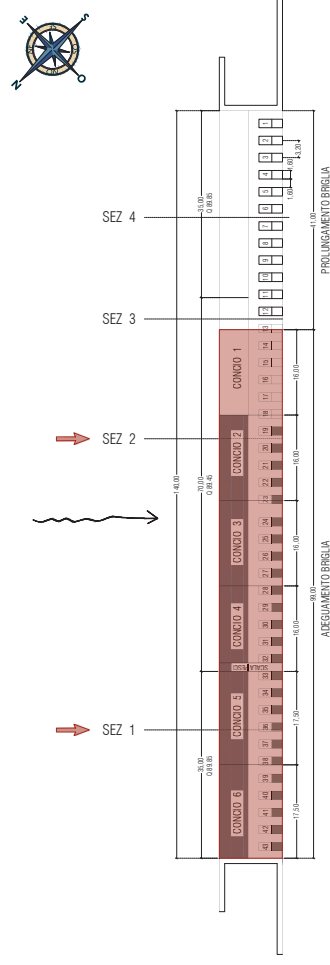

**PROGETTO ESECUTIVO - 1° STRALCIO
CARATTERIZZAZIONE DEL MANUFATTO ESISTENTE**

Rifacimento conc. 2.3.4-5-6 Cis, cassetta e armatura		VAR.		2022-1087-PR-SF.06.2	
REVISIONE	DATA	DESCRIZIONE	REAGENTO	VERIFICATO	APPROVATO
00	14.11.2022	Emissione	MCA	RR	RR